

# 12' Trade Show Tower

## Assembly Instructions

### Rounded Bar Components

- |                             |                        |
|-----------------------------|------------------------|
| 1. Rounded Bars with Clicks | 5. Central Crossmember |
| 2. Rounded Bars             | 6. Bolt Sockets        |
| 3. Rounded Vertical Bars    | 7. Bolts               |
| 4. Horizontal Bars          | 8. Graphic             |

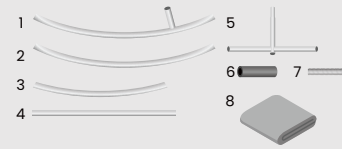

### 1 Assemble The Frame

Connect each of the 2 banner support rings together. Each of these rings have 10 outer ring parts. Joints should be connected by paring their numbered pipe and socket. This will result in 2 rings.

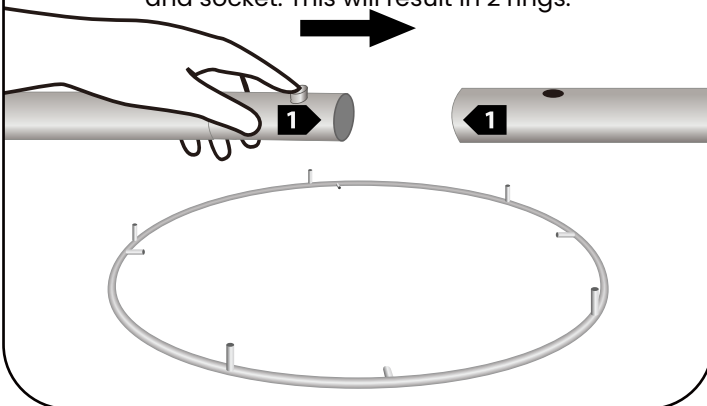

### 2 Assemble The Frame

Connect banner support ring central crossmember. Joints should be connected by paring their numbered pipe and socket. This will result in a connected crossmember.

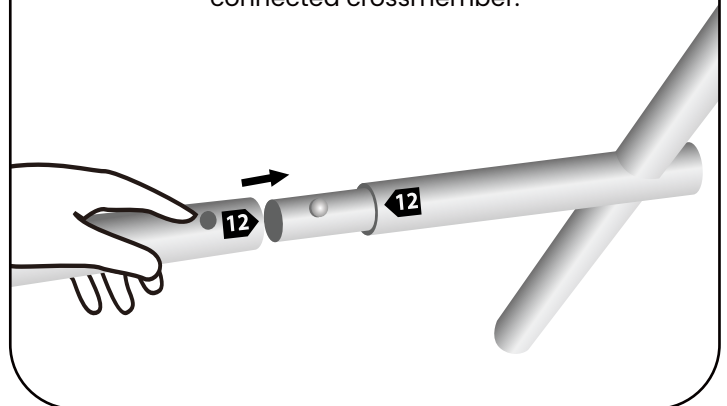

### 3 Assemble The Frame

Place the connected banner ring crossmember inside the top ring. And connect the bolt sockets to each of the 4 ends. Joints should be connected by paring their numbered pipe and socket.

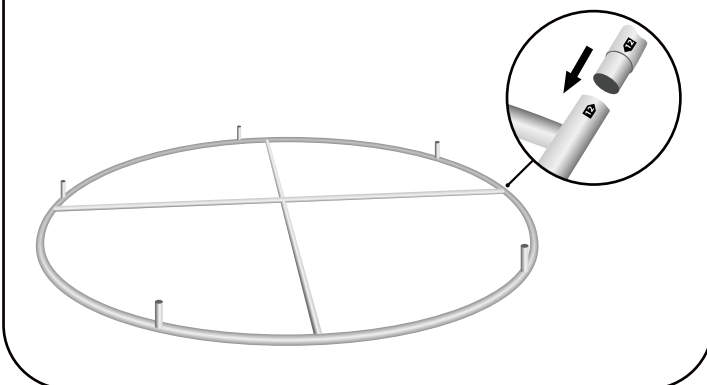

### 4 Assemble The Frame

Construct each of the vertical bars by pairing their numbered pipe and socket and adding a bolt socket to each end. connecting a bolt socket to each end. Joints should be connected by paring their numbered pipe and socket. Then connect all 4 of the curved uprights the bottom banner support ring with the provided bolts.

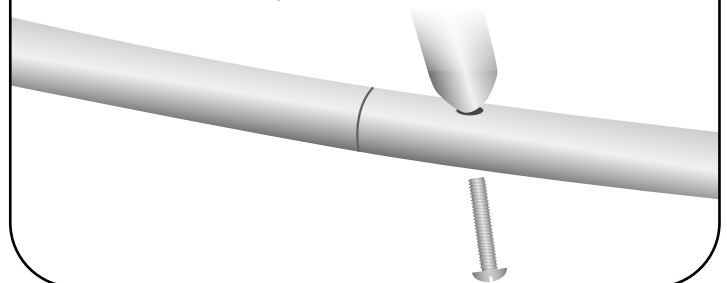

### Storage & Care:

Store in a cool dry location. Clean hardware with a damp cloth. Machine wash the graphics in cold water on a gently cycle. Air dry only. Use a steamer for wrinkles. Never dry-clean.

# 12' Trade Show Tower

## Assembly Instructions

### Rounded Bar Components

- 1. Rounded Bars with Clicks
- 2. Rounded Bars
- 3. Rounded Vertical Bars
- 4. Horizontal Bars
- 5. Central Crossmember
- 6. Bolt Sockets
- 7. Bolts
- 8. Graphic

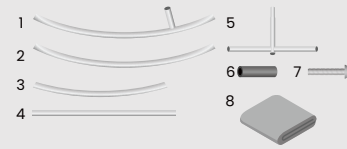

### 5 Assemble The Frame

Set the bottom banner support ring onto the vertical bars. Attach the top ring to each socket using the provided bolts.

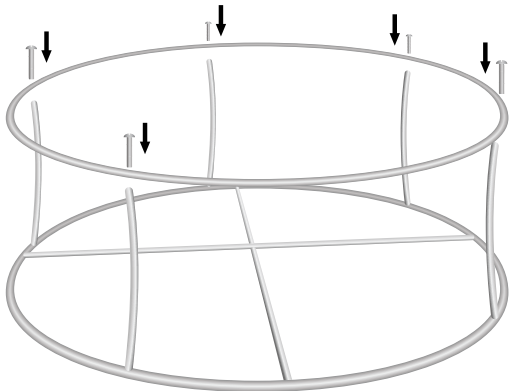

### 6 Install The Graphic

Flip the banner support ring over so that the bottom ring is up. Unzip the graphic and slip it over the bottom ring. Zip the graphic closed around the top ring.

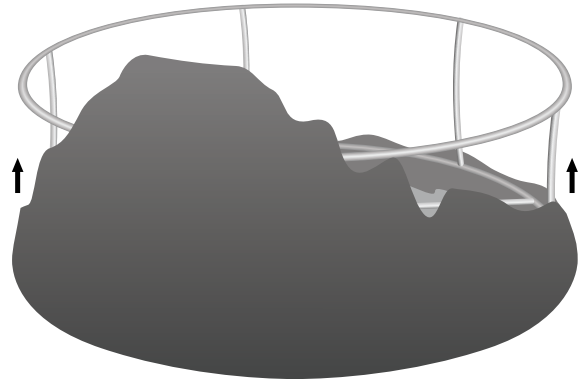

### 7 Install The Graphic

Attach the connected banner ring crossmember to the bottom ring with the provided bolts.

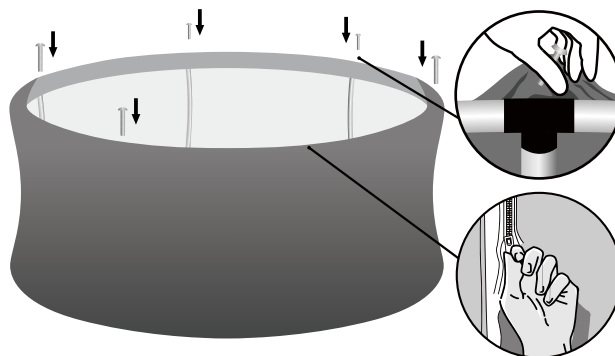

### Storage & Care:

Store in a cool dry location. Clean hardware with a damp cloth. Machine wash the graphics in cold water on a gently cycle. Air dry only. Use a steamer for wrinkles. Never dry-clean.

# 12' Trade Show Tower

## Assembly Instructions

### Tower Components

- 1. Vertical Bars
- 2. Horizontal Bars
- 3. Bars with Support Rings
- 4. Corner Brackets
- 5. Allen Wrench
- 6. Bolts
- 7. Graphic

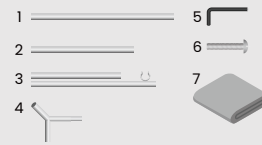

### 8 Assemble The Frame

Connect the top and bottom bars. Joints should be connected by pairing their numbered pipe and socket. Each corner will use one of the 8 plastic corner brackets. This will result in the top and bottom frames.

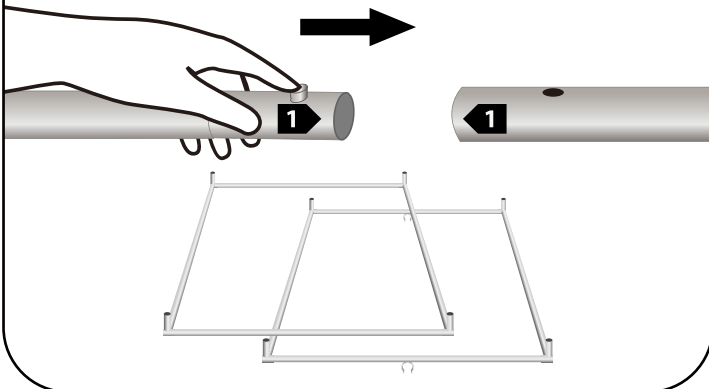

### 9 Assemble The Frame

Assemble the horizontal and vertical bars. Joints should be connected by pairing their numbered pipe and socket. Connect the vertical bars to the bottom assembly's 3 way plastic connector. Connect each horizontal bar to the center point of the vertical with the provided bolts.

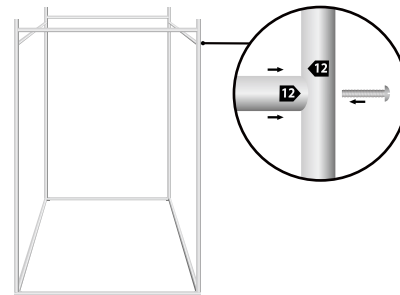

### 10 Assemble The Frame

Tip the assembled tower on its side. And connect the top assembled frame.

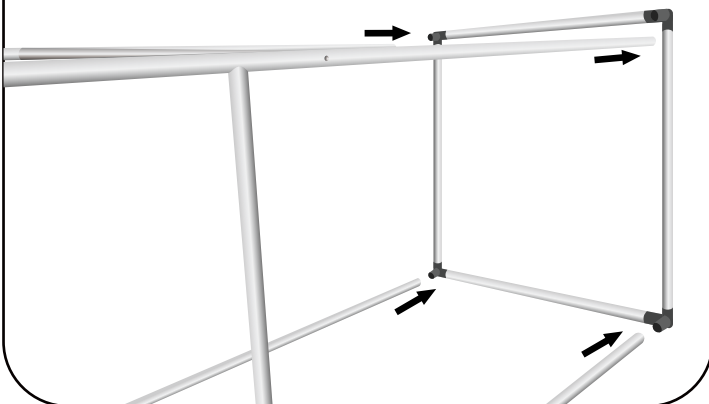

### 11 Install The Graphic

Unzip the bottom of the graphic sleeve and stretch it over the top of the tower. Pull the sleeve down to the bottom of the tower. Zip the Bottom of the Tower sleeve closed.

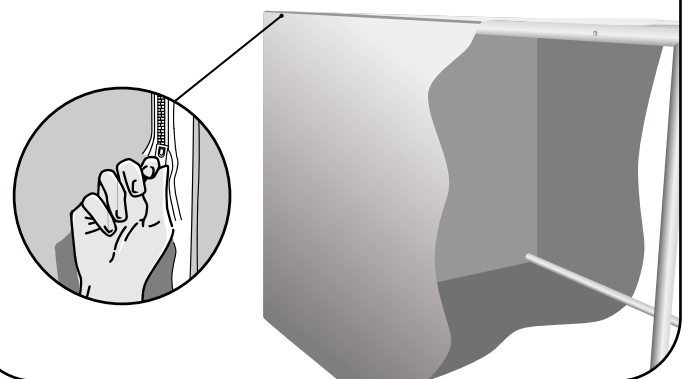

### Storage & Care:

Store in a cool dry location. Clean hardware with a damp cloth. Machine wash the graphics in cold water on a gently cycle. Air dry only. Use a steamer for wrinkles. Never dry-clean.

# 12' Trade Show Tower

## Assembly Instructions

### Tower Components

- 1. Vertical Bars
- 2. Horizontal Bars
- 3. Bars with Support Rings
- 4. Corner Brackets
- 5. Allen Wrench
- 6. Bolts
- 7. Graphic

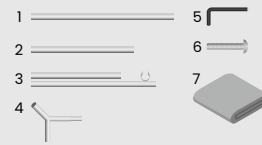

### 12 Install The Graphic

Attach the banner support rings with the provided bolts to the center of each side of the tower's top.

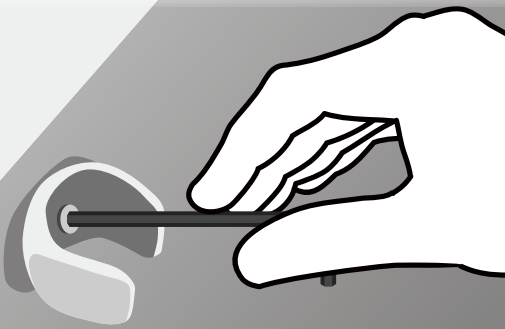

### 13 Install The Tower

Connect the clips at the center of each side of the top assembly to the cross members of the banner support rings.

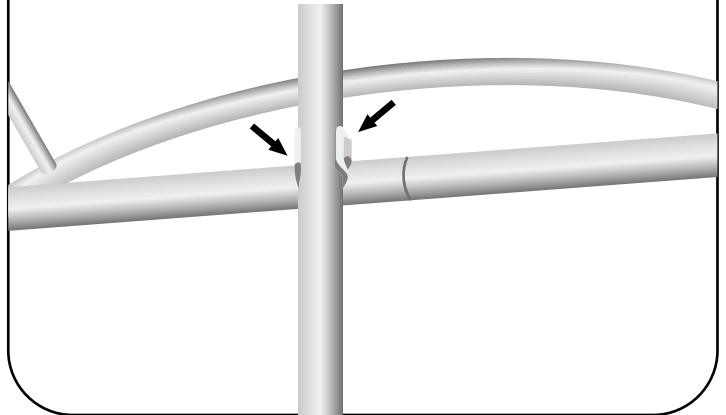

### 14 Install The Tower

Tip the tower into place.

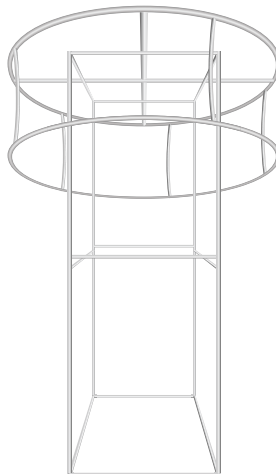

### Storage & Care:

Store in a cool dry location. Clean hardware with a damp cloth. Machine wash the graphics in cold water on a gently cycle. Air dry only. Use a steamer for wrinkles. Never dry-clean.

# Hard Case Podium

## Assembly Instructions



(1) Case Shell  
(top)



(1) Case Shell  
(bottom)



(1) Counter Top



(4) Poles



(1) Podium Graphic

### 1 Assemble the Frame

Place Case Shell (bottom) flat on the floor and insert the poles into each of the holes. Then align Case Shell (top) over the poles and press firmly into place.



### 2 Install Podium Graphic

Starting at the base pull the Podium Graphic the Case Shell (bottom). Then pull up over Case Shell (top), one corner at a time. Adjust and straighten as needed then zip up the back.



### 3 Install The Counter Top

Place the counter top over Case Shell (top) and press down to ensure the grooves fit over the edge of the case.

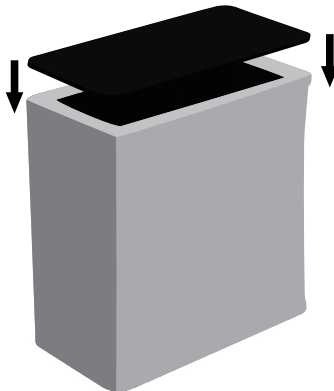

### 4 Hidden Storage

Use the inside of the podium as an extra storage space for marketing collateral or personal items by unzipping the back and placing items inside.

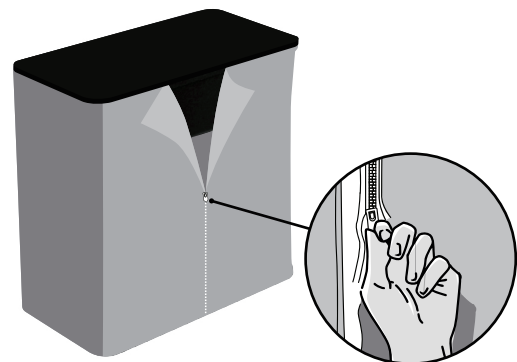

### Storage & Care:

Store in a cool dry location. Clean hardware with a damp cloth. Machine wash the graphics in cold water on a gently cycle. Air dry only. Use a steamer for wrinkles. Never dry-clean.

# Media Rack

## Assembly Instructions

1. Curved Base (2)
2. Corded Vertical Side Poles (2)
3. Top End Cap Pole (1)
4. Bottom End Cap Pole (1)
5. Media Rack Support Pole (1)
6. Media Mount (1)
7. Screw (1)
8. Literature Rack Clips (4)
9. Literature Rack (2)
10. Media Rack Graphic

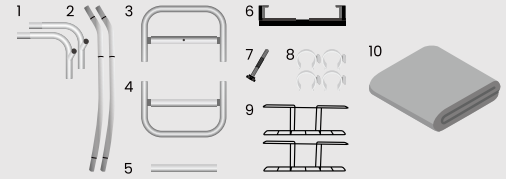

### 1 Assemble The Frame

Connect the poles by matching the numbers.

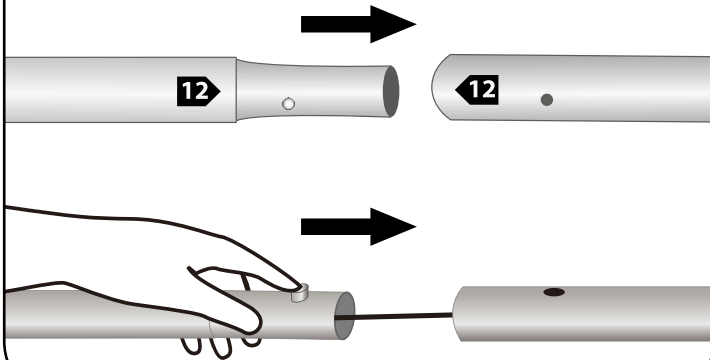

### 2 Install The Media Rack Graphic

Carefully pull the Media rack Graphic (10) over the frame, ensuring both sides are pulled down at the same time. Zip the end to secure the graphic.

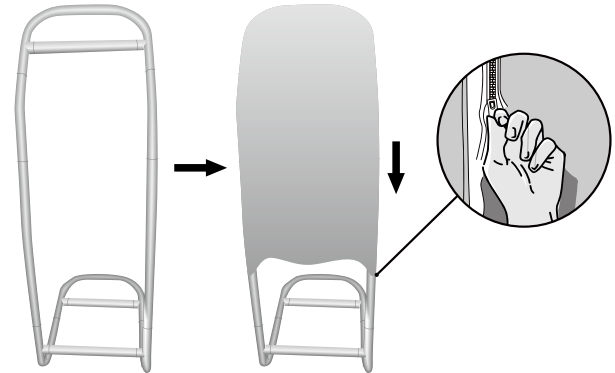

### 3 Install The Media Mount

Install the Media Mount (6) by running the Screw (7) through the back of the stand, through the hole in the Media Rack Support Pole (5). Tighten Screw into the back of Media Mount to secure in place.

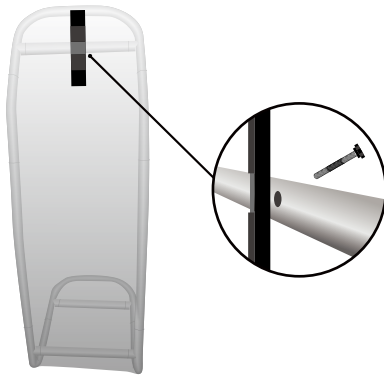

### 4 Install Literature Rack Clips

Install Literature Rack Clips (4) on each of the side bars. Hand Literature Rack from the clips.

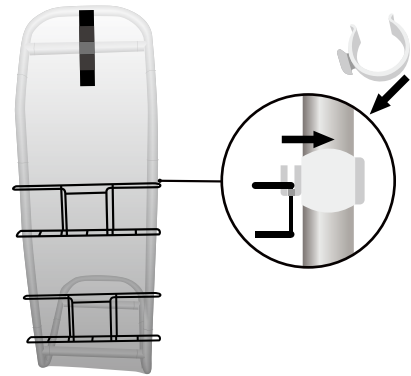

### Storage & Care:

Store in a cool dry location. Clean hardware with a damp cloth. Machine wash the graphics in cold water on a gently cycle. Air dry only. Use a steamer for wrinkles. Never dry-clean.

# Triangle Display Rack

## Assembly Instructions

1. Triangle Table Top
2. Triangle Table Base
3. Triangle Racks (x3)
4. Table Poles (x3)
5. Rack Poles (x6)

6. Graphic
7. Screws

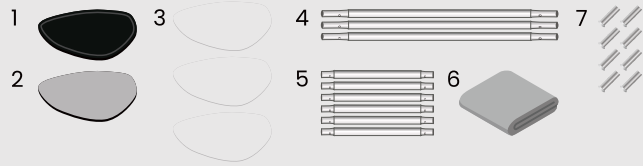

### 1 Assemble the Frame

Place bottom frame flat on the floor and insert the poles into each of the holes. Connect all of the poles together by matching each number to its counterpart.

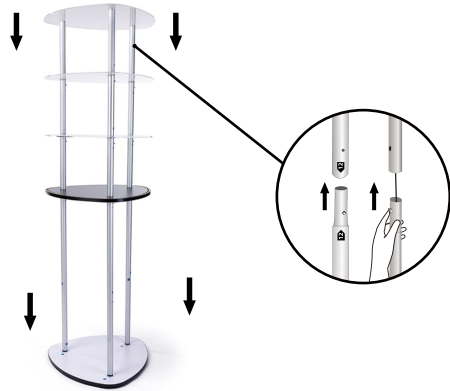

### 2 Assemble the Frame

Tighten everything

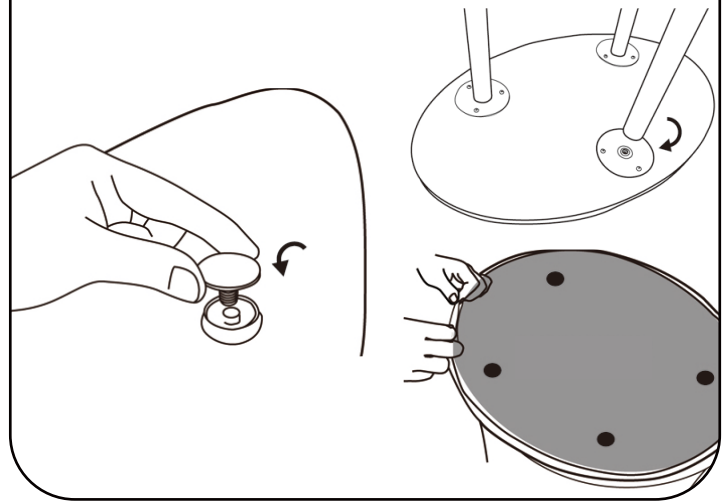

### 3 Install the Graphics

Carefully pull the graphic print over the frame and zip up

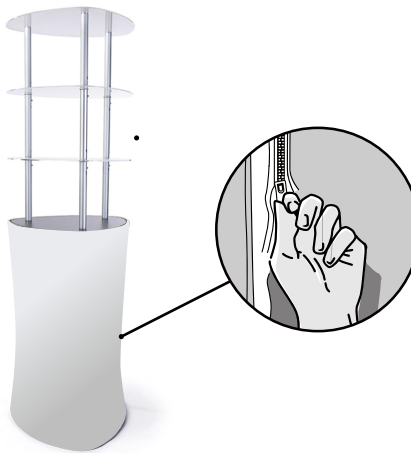

### Storage & Care:

Store in a cool dry location. Clean hardware with a damp cloth. Machine wash the graphics in cold water on a gently cycle. Air dry only. Use a steamer for wrinkles. Never dry-clean.